



COMMUNITY UNIT SCHOOL DISTRICT 200

# Boundary Adjustment Recommendation

January 14, 2015



Inspiring in Everyone a Passion to Excel

# Background

- Fall 2014 – Enrollment Committee identified an enrollment strategy concern at **Hawthorne** and **Pleasant Hill** Elementary Schools.
- Several years ago, **Hawthorne** experienced a growth in enrollment.
  - *New families* from Covered Bridges enrolling in the District were asked to enroll at Pleasant Hill Elementary.
  - However, *new students of existing* Hawthorne families were able to continue enrolling at Hawthorne.



# Background

- According to the current District 200 boundary map, students who live in the Covered Bridges Apartments *should* attend **Hawthorne**.

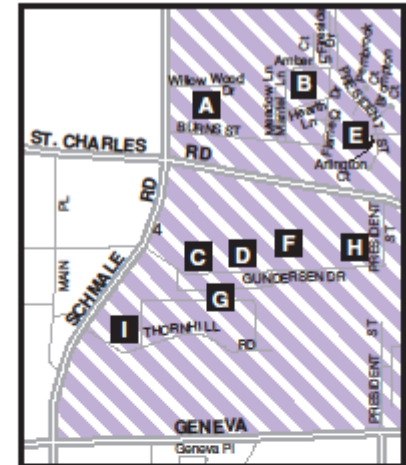

Students who live in the area east of Schmale Road and north of Geneva Road are assigned as noted:

	<b>Elementary School</b>	<b>Middle School</b>	<b>High School</b>	
<b>A</b>	Covered Bridges	Hawthorne	Franklin	Wh. North
<b>B</b>	Yorktree	Sandburg	Monroe	Wh. North
<b>C</b>	West Haven	Longfellow	Franklin	Wh. North
<b>D</b>	Parkway Commons	Pleasant Hill	Monroe	Wh. North
<b>E</b>	Concord Pointe	Washington	Franklin	Wh. North
<b>F</b>	St. Charles Square	Washington	Franklin	Wh. North
<b>G</b>	Parkway Commons	Washington	Monroe	Wh. North
<b>H</b>	Autumn Ridge	Whittier	Monroe	Wh. North
<b>I</b>	The Preserve	Sandburg	Monroe	Wh. North



# The Current Scenario

- There are approximately 150 students from Covered Bridges.
  - Approximately 100 attend Pleasant Hill ( $\frac{2}{3}$ )
  - Approximately 50 attend Hawthorne ( $\frac{1}{3}$ )
- The enrollment distribution of students is currently manageable for both schools.
- Neither building can accommodate the *entire* student population from Covered Bridges.



# The Challenge

Without any change in student assignment:

- All students from Covered Bridges would eventually attend Pleasant Hill.
- The school could not accommodate this increase in enrollment.



# The Options

1. Maintain current enrollment structure
2. Assign students each year as they enroll
3. Adjust the current boundary to distribute future enrollment between two buildings



# Community Engagement

- District staff reviewed options with several stakeholder groups to solicit feedback.
  - Covered Bridges families and management
  - Pleasant Hill families and staff
  - Hawthorne families and staff
- The Enrollment Committee met January 8<sup>th</sup> to review the recommendation and provide feedback.



**Covered Bridges Current Enrollment 2014-2015**

**Proposed Hawthorne**

**Students**

Blding #	Units	1 Bedrm	2 Bedrm	3 Bedrm	Hawthorne	PH				
1	8	0	4	4	1					
2	16	12	4	0		4				
3	12	0	8	4	2	5				
4	36	9	27	0	5	8				
5	24	12	12	0	2	6				
6	24	16	8	0		1				
7	36	20	12	2	4	8				
	156	69	75	10	14	32	<b>46</b>	<b>Total Students Units 1-7</b>		
	<b>Total 2 &amp; 3 Bedrooms</b>		<b>85</b>							

**Proposed Pleasant Hill**

**Students**

Blding #	Units	1 Bedrm	2 Bedrm	3 Bedrm	Hawthorne	PH				
8	36	12	24	0	3	17				
9	30	12	18	0	7	9				
10	30	6	24	0		17				
11	12	6	4	2		4				
12	8	0	4	4	6	2				
13	30	12	18	0	3	9				
14	16	12	4	0	5	2				
15	16	0	8	8	7	2				
16	16	12	4	0	1	7				
17	12	6	4	2	1	1				
18	206	78	112	16	33	70	<b>103</b>	<b>Total Students Units 8-17</b>		
	<b>Total 2 &amp; 3 Bedrooms</b>		<b>128</b>							
							149	<b>Total Students Covered Bridges</b>		



# Administrative Recommendation

- The complex will be divided into a west section and an east section.
- The proposed recommendation will not affect any *current* Hawthorne or Pleasant Hill families.



# Administrative Recommendation

- **The west section will attend Hawthorne Elementary.**
  - Contains approximately  $\frac{1}{3}$  of the student population from Covered Bridges
  - Students will continue to Franklin Middle School
- **The east section will attend Pleasant Hill Elementary**
  - Contains approximately  $\frac{2}{3}$  of the student population from Covered Bridges
  - Students will continue to Monroe Middle School



# Administrative Recommendation

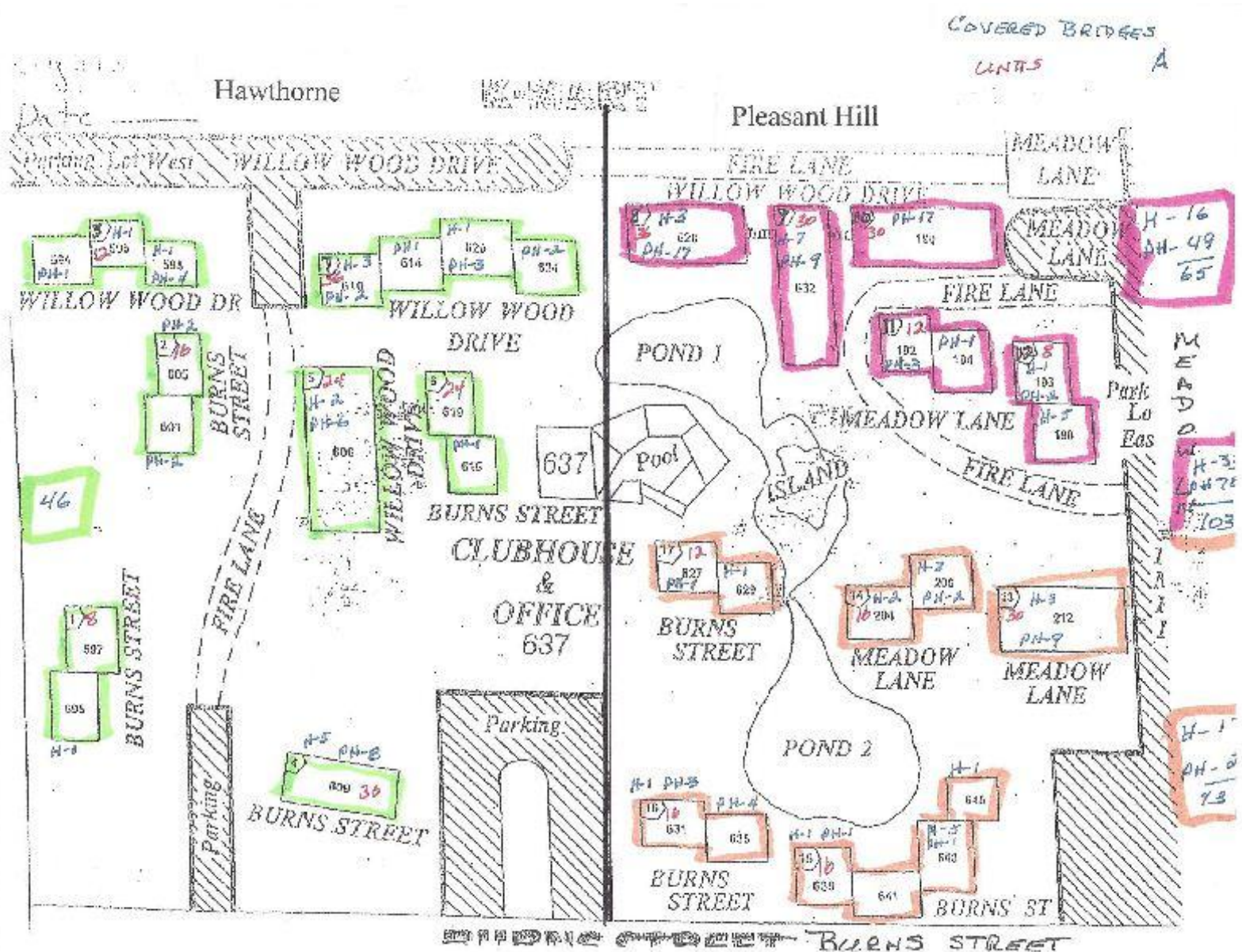

# Administrative Recommendation

- Any new families from Covered Bridges that enroll in District 200 will be asked to follow the proposed boundary line.
- Existing Hawthorne and Pleasant Hill families will remain at their current school.
- Any new students from existing families will be able to enroll at the same school as their sibling(s).



# The Options

1. Maintain current enrollment structure
2. Assign students each year as they enroll
3. Adjust the current boundary to distribute future enrollment between two buildings



Questions?

